

SONOSCALE AS300

Order number: 100010206

Technical Data:

Operating frequency:	300 kHz \pm 4 %
Beam width (-3 dB):	10° \pm 2°
Max. driving voltage at 2 % duty cycle tone burst:	400 V _{pp}
Min. transmit sensitivity at optimal transmit frequency:	95 dB re 1 μ Pa/V at 1 m
Min. receive sensitivity at optimal receive frequency:	-180 dB re 1 V/ μ Pa
Capacitance (1 kHz):	450 \pm 100 pF
Weight:	2 g
Operating temperature:	-40 to +90 °C
Housing:	POM
Acoustic window:	filled epoxy

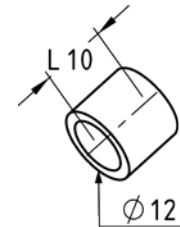
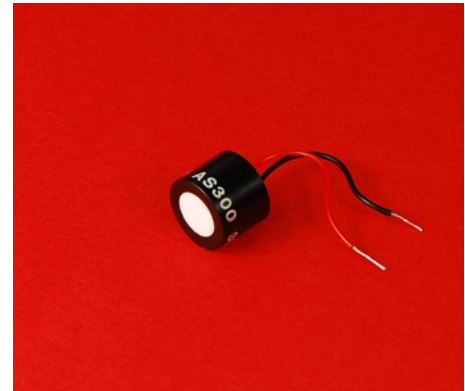

Technical specifications may be changed by SONOTEC without further notice.

Transmit and Receive Voltage Response:

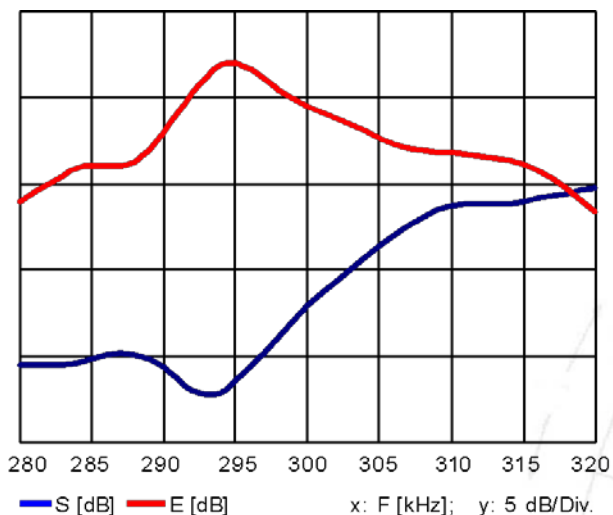

Directivity Pattern:

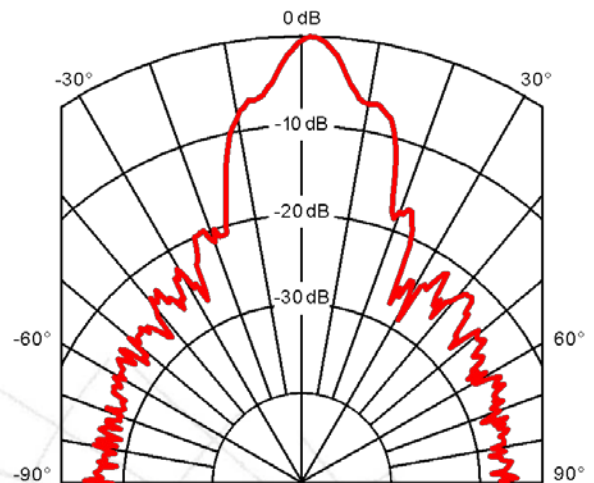

SONOTEC 

SONOTEC Ultraschallsensorik Halle GmbH
 Nauendorfer Straße 2, 06112 Halle an der Saale
 www.sonotec.de

E-Mail: sonotec@sonotec.de
 Tel.: +49 (0)345 / 1 33 17- 0
 Fax: +49 (0)345 / 1 33 17-99